

6

STEP 6: On-screen setup and activation

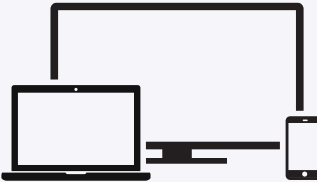

Follow the instructions on your TV screen.



Activate your streaming player by using your computer or smartphone to link to a Roku account.

NOTE: Roku does not charge for activation support – beware of scams.

Common questions

Why do I need to create a Roku account?

Before you can start streaming, channels must be downloaded and installed on your streaming player. You'll need a Roku account to access the Roku Channel Store, manage your subscriptions, view your purchase history, and add a payment method. For more info, visit go.roku.com/whyaccount

Why do I need to enter a credit card?

Saving a payment method makes it easy to rent or buy movies on demand, subscribe to popular services, and enroll in free trials. Charges will not be made without your authorization. For more information, visit go.roku.com/paymenthelp

What should I do if my streaming player is not connecting to my wireless network?

Your streaming player connects to your wireless network the same as your laptop or smartphone. If these other devices can access the internet, then your streaming player should be able to do the same. Make sure to select the same network name, and enter the same password you use with the other devices. Remember that passwords are case-sensitive and easy to enter incorrectly. For more help, visit go.roku.com/wireless

Can I take my Roku streaming player with me when I travel?

Yes, you can bring your streaming player and watch your favorite entertainment when you travel! Remember to also bring a USB power adaptor (like your phone charger), remote, and any cables you use to connect your streaming player at home. Make sure your destination has a good internet connection. You may need a computer or smartphone to help connect your streaming player to a new wireless network. For more details, visit go.roku.com/travelwithroku

Adhesive strip instructions

You have the option of attaching your streaming player to your TV using the included double-sided adhesive strip. This strip is removable and will not leave a sticky residue. However, it can only be used one time! Keep in mind that your streaming player requires a direct line of sight with your remote control. To order more strips, go to roku.com/accessories

To apply adhesive strip

- Choose a flat surface to attach your streaming player. Make sure the area is clean and in line of sight to your remote before attaching.
- Remove striped liner from the double-sided adhesive strip. Press adhesive to the bottom of the streaming player.
- Remove other liner. Firmly press the streaming player to the desired location for 30 seconds.

To remove adhesive strip

- Hold the streaming player in place. Gently pull adhesive strip sideways.
- Do not pull adhesive strip towards you.
- Stretch the strip slowly to the side (at least 15 inches) to release.

Need more help getting started?

go.roku.com/rokuhd



Video tutorials



Wireless help

Getting the most out of your Roku streaming player.

go.roku.com/usingroku



Add channels



Mobile app

Tips, what's streaming for free, and more...

blog.roku.com



Roku Blog



Roku

© 2019 Roku, Inc. All rights reserved. ROKU and the ROKU logo are the registered trademarks of Roku, Inc. HDMI, the HDMI logo, and High-Definition Multimedia Interface are the trademarks or registered trademarks of HDMI Licensing, LLC. All other logos and trademarks herein not owned by Roku, Inc. are the property of their respective owners.

ROKU HD

Quick Start Guide



4100000599_1

What's included



Roku HD streaming player



Removable adhesive strip



Two AAA Duracell® batteries



Remote

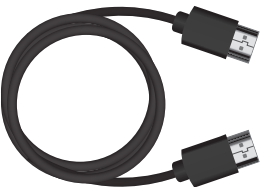

High Speed HDMI® Cable

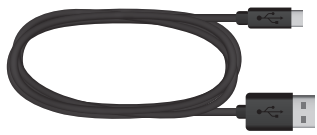

USB power cable

Details



HDMI USB power Reset



Front



Top



Back



Bottom

Setup

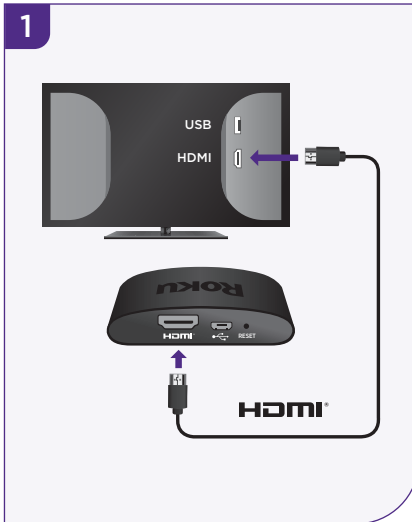

STEP 1: Connect to TV

Use the included High Speed HDMI® Cable (or your own HDMI® cable) to connect your streaming player to your TV.

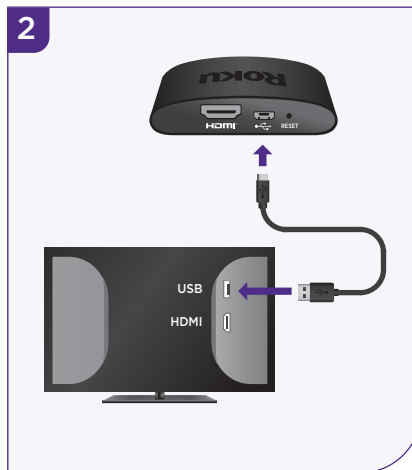

STEP 2: Connect to power

Use the included USB power cable to connect to the USB port on your TV.

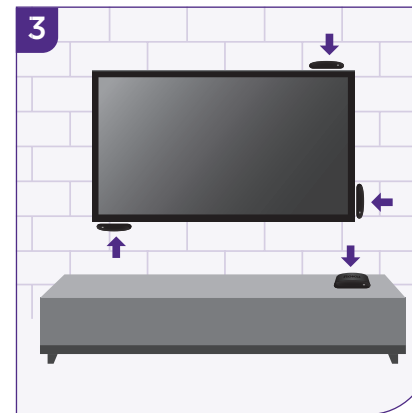

STEP 3: Position Roku® streaming player

Place the streaming player near your TV.

The streaming player can be attached to your TV with the included double-sided adhesive strip. The strip is for single-use and can be removed.

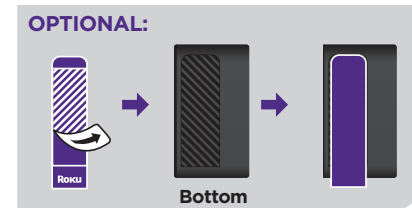
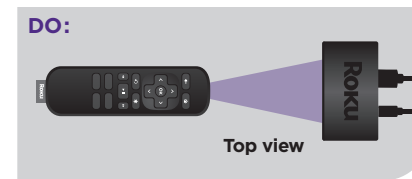

DO make sure that the front of your streaming player has direct line of sight with your remote control.

DO NOT place your streaming player behind the TV.

DO NOT place inside a TV cabinet. Doing so may cause overheating.

For proper use, see **adhesive strip instructions** located at the end of this Quick Start Guide.

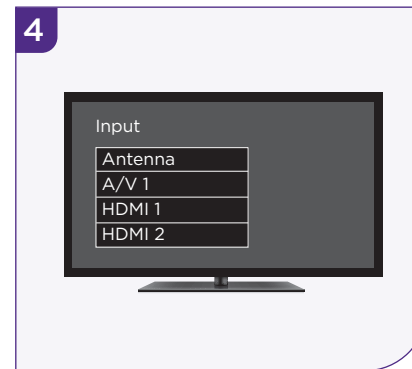

STEP 4: Power on TV and select input

Use your TV remote to power on your TV and select the input you used to connect your streaming player.

For help on how to select the correct input, visit go.roku.com/selectinput



STEP 5: Insert batteries

On the back side of the remote, slide open the battery cover. Insert included Duracell® batteries placing the negative (-) ends in first.