

ROKU

Indoor
Smart Plug
SE

**Quick Start
Guide**



What's included

- Roku Indoor Smart Plug SE

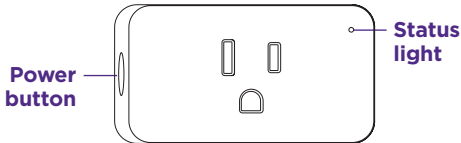

What you'll need

- Your smartphone

Let's get started

STEP 1: Download the Roku Smart Home app

Scan the QR code below to download the Roku Smart Home app on your smartphone. Sign in with your Roku account or create one.

You'll need



Smartphone & app



Message & data rates may apply.

STEP 2: Insert plug

Insert your smart plug into a power outlet. The status light will begin flashing **BLUE** to show it's in pairing mode.

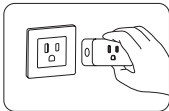

If it's not flashing **BLUE**, press and hold the Power button until it begins to flash.

STEP 3: Pair to app

In the Roku Smart Home app, tap the “+” button, then “**Add Device**” to find “**Indoor Smart Plug**.” Follow the instructions to finish setup.

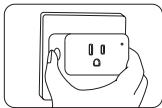

What's that light mean?

Status Light	State
BLUE - Solid	Connected
BLUE - Slowly flashing	Connecting to Wi-Fi®
BLUE - Quickly flashing	In pairing mode
NO LIGHT	Socket power off



Use the **Roku Smart Home app** to control your smart plug from anywhere.

FCC WARNING

Any changes or modifications not expressly approved by the party responsible for compliance could void the user's authority to operate the equipment. This device complies with part 15 of the FCC Rules. Operation is subject to the following two conditions: (1) This device may not cause harmful interference and (2) this device must accept any interference received including interference that may cause undesired operation.

FCC RADIATION EXPOSURE STATEMENT

This equipment complies with FCC radiation exposure limits set forth for an uncontrolled environment. This equipment should be installed

and operated with minimum distance of 20 cm between the radiator and your body. This transmitter must not be co-located or operating in conjunction with any other antenna or transmitter.

Need help?



Setup
videos



Common
questions



Tips and
tricks

Visit go.roku.com/plugs

Roku

© 2022 Roku, Inc. All rights reserved. Roku, the Roku logo, Roku Smart Home, and the Roku Smart Home logo are the trademarks or registered trademarks of Roku, Inc.

4100000871_01